

# **P.DG A1010**

**ADSL2+ Data Gateway**



**Compact and stylish, P.DG A1010 provides a cost effective, efficient and robust broadband Home connectivity. Featuring one ETH port, P.DG A1010 represents the ideal solution for entry level broadband services.**

- **ADSL 2/2+**
- **Annex A,B options**
- **Ethernet 10/100 Base-T/TX**
- **USB 1.1d**
- **IP QoS**
- **Security and firewall**
- **Smart Setup**

P.DG A1010 is a versatile and cost-effective data router for reliable and high-speed broadband connectivity. Subscribers can easily surf the Internet, manage e-mails and communicate in a safe and secure environment. Furthermore, the user can extend his private network by connecting an external access point or switch to the available Ethernet port.

By using a best-in-class and field-proven ADSL2+ chipset platform, P.DG A1010 delivers the highest level of interoperability with central office equipment, resulting in fast service introduction and no additional qualification costs.

ADBB can reduce Service Providers installation and Customer Support issues making available an optional 'Smart Setup' software wizard, enabling broadband access in a very user friendly way and in less than 10 minutes.



# P.DG A1010



## LEDs

Power
Ethernet port
USB Device
ADSL Link
Internet

## Buttons

1 x Reset Button
1 x Power Button

## Power Adapter

INPUT: 100-240Vac 50/60Hz 0.3A
OUTPUT: 12 VDC 0.5 A

## Environmental Specifications

Temperature:
• Operating: 0 to 40 °C
• Non Operating: -20 to 65 °C
Relative Humidity:
• Operating: 10% to 85% non-condensing
• Non Operating: 5% to 95% non-condensing

## Agency Approvals and Certifications

CE mark
ITU-T K21 *
RoHS
WEEE
EuP

## Physical Specifications

Dimensions: 139 x 121.5 x 33 mm
Weight: 200 gr

## Standard Package Content

P.DG A1010
Power adapter
Ethernet cable
USB cable
Phone cable
CD
Safety leaflet

## MAIN FEATURES

<b>WAN interface</b>	1 ADSL Line port (RJ-11 plug) supporting the following standards: ADSL (G.992.1, G992.2, T1.413, G994.1, .997.1) ADSL2 (G.992.3) ADSL2+ (G992.5) Annex A/Annex B are available in different product versions
<b>LAN interface</b>	N° 1 10/100BASE-T/TX Ethernet port (RJ-45 plug), compliant IEEE 802.3, with auto MDIX and auto-negotiation. N° 1 USB Device v 1.1
<b>ATM features</b>	ATM (AAL5) payload format UBR, VBR-nrt, VBR-rt, CBR traffic classes Up to 8 PVC Pre-emptive SAR Multiple physical queues (up to 8) per traffic class, with priority-based scheduling support*
<b>WAN Protocol Encapsulation</b>	Bridged/Routed Ethernet over ATM (RFC 2684 / RFC 1483) PPP over Ethernet (RFC 2516) PPP over ATM (RFC 2364) IP over ATM (RFC 1577) MTU settable
<b>Routing / Bridging</b>	IPv4 Static routing DHCP Server/Client VPN pass-through NAT/NAPT (with ALGs) DNS relay NTP IGMPv2 proxy
<b>QoS</b>	Traffic shaping (ATM layer) IP QoS Priority-based scheduling (up to 8* queues, max 4 per PVC ) DSCP/TOS remarking
<b>Security Management</b>	Programmable firewall Broadband Forum TR-069 TFTP client for remote firmware upgrade Diagnostics and LOGs Telnet with CLI WEB server with Admin/User configuration Pages

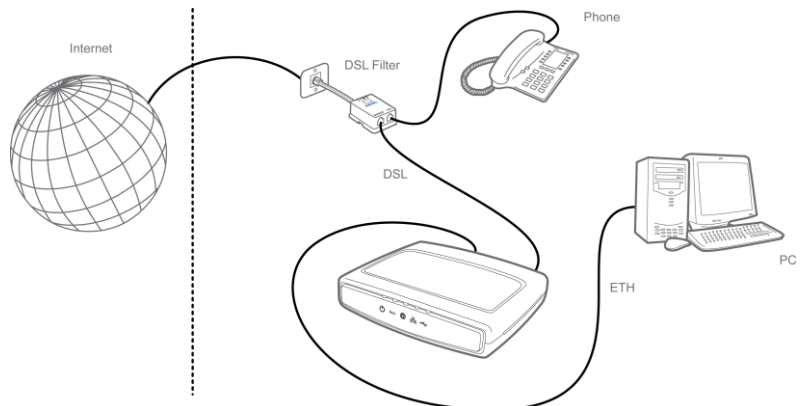

(\*): optional on request